

BPC Central Small Diameter Package I

M. Antonio Leyva, P.E.

Manager – Engineering

Carmen C. Groth, P.E.

Project Engineer

Marisol V. Robles

SMWVB Program Manager

Fred Flores

Contract Administrator

Ian Patrick Toohey, P.E.

Project Engineer of Record

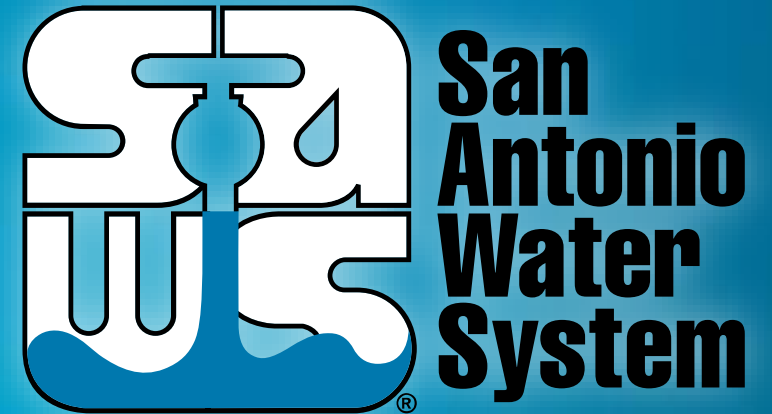

Non-mandatory Pre-Bid Meeting

August 15, 2019

MAKING SAN ANTONIO
WATERFUL 

Oral Statements

Oral statements or discussion during the pre-bid meeting today will not be binding, nor will it change or affect the terms or conditions within the Plans and Specifications of this Project. Changes, if any, will be addressed in writing only via an Addendum.

Agenda

- General Information
- Small, Minority, Women, and Veteran-Owned Business (SMWVVB Requirements)
- IFB Schedule
- Bid Packet Preparation
- Contract Requirements
- Vendor Registration
- Key Reminders
- Technical Information

General Information

- This is a Non-Mandatory pre-bid meeting.
- This presentation and the sign-in sheet will be posted to the SAWS website.
- The construction estimate is \$3,465,302.77
- Construction services being procured through IFB
- Completion is scheduled for 365 calendar days.

Aspirational SMWB Goal

Industry	Aspirational SMWB Goal
Construction	20%

The aspirational SMWB goal is 20% of your total bid price.

Accepted SMWVB Certification Agency

- **South Central Texas Regional Certification Agency**
(Includes the Texas Historically Underutilized Business “HUB” Program)

Minimum Qualifications for SMWVB recognition:

- SBE-Certified (even MBEs and WBEs)
- ***Local office or local equipment yard***

Accepted SMWVB Certifications

- Small Business Enterprise (SBE)
- Minority Business Enterprise (MBE) (Includes AABE; ABE; HABE and NABE)
- Woman-owned Business Enterprise (WBE)
- Veteran-owned Business Enterprise (Tracked)

Good Faith Effort Plan (GFEP) FAQs

- **Q: Is the 20% SMWB goal mandatory?**

A: No, but we ask prime contractors to do their best with good faith outreach efforts. If the goal is not met, proof of outreach efforts is required with the submittal.

- **Q: What if I am having trouble finding SMWB subcontractors?**

A: Please email the SMWVB Program Manager with the scopes of work you are seeking. You will receive lists of local SMWVB-certified firms to contact.

- **Q: What if my business is SMWB-certified? Do I need to find SMWB subs?**

A: If your firm is SMWVB-certified, you will most likely meet the goal. However, the GFEP is a required document, and a good faith outreach effort is still necessary.

- **Q: Do I need to include all my subcontractors in the GFEP or just those that qualify towards the SMWB goal?**

A: All subcontractors need to be included in the GFEP, even those that may not count towards the SMWB goal.

- **Q: What if I have questions about the GFEP?**

A: Please contact the SMWVB Program Manager at 210-233-3420, or at Marisol.Robles@saws.org. GFEP questions can be asked at any time before the submittal is due.

Post Award: Subcontractor Payment & Utilization Reporting (S.P.U.R.) System

1. Subcontractor & Supplier Payment Tracking
2. Subcontractor and Supplier Additions or Substitutions
3. LCP Tracker
4. Must be Current and Accurate before Retainage is released

<https://saws.smwbe.com>



San Antonio Water System

OUR MAIN SITE CONTACT SUPPORT

Subcontractor Payment & Utilization Reporting System

Log In

System Training
Learn how to fully utilize our system with a live trainer
Training

About the System
Learn more about this system and how it works today
Information for Vendors

Account Access
Lookup Vendor accounts or reset user passwords
Account Lookup
Forgot Password

The Subcontractor Payment & Utilization Reporting System is powered by B2Gnow Software © Copyright 2018.

IFB Schedule

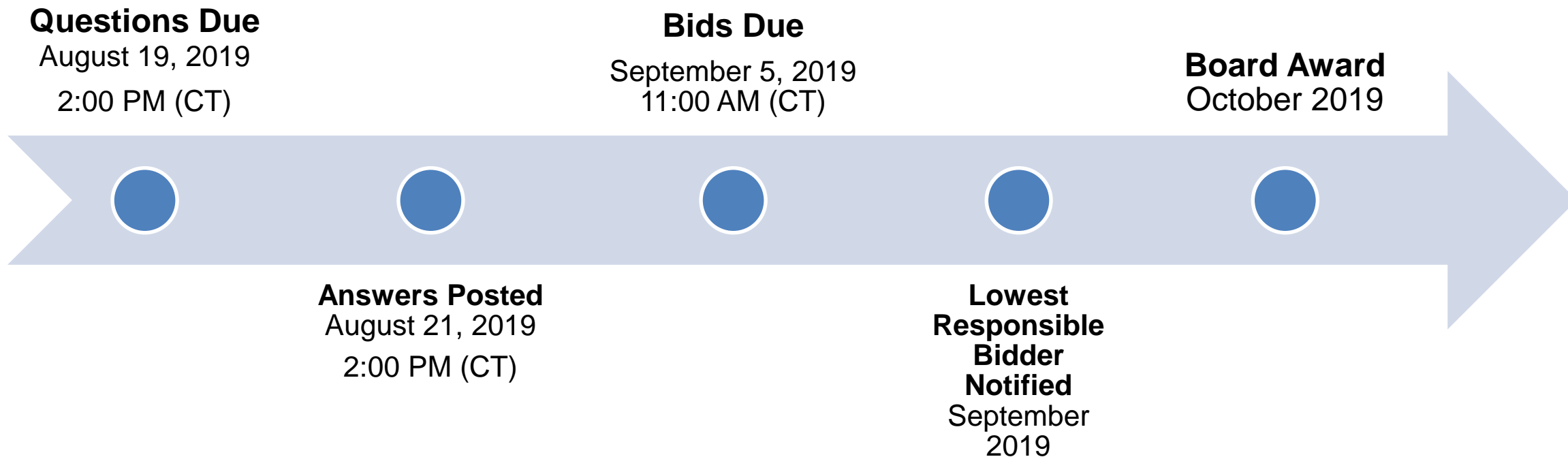

Bid Packet Preparation

- Utilize the Bid Packet Checklist within the specifications
- Double check all mathematical calculations and verify all extensions
- Addendums are now acknowledged on the Bid Proposals
- Ensure Mob and Prep of ROW do not exceed the percentage
- References and contact information must be verified prior to submitting bid(s)

Contract Requirements

Prevailing Wage Rate and Labor Standards – Section 2.10 of the General Conditions

- Certified payroll to be submitted on weekly basis
- Wage decisions are included within the specifications
- Contractors to utilize LCP Tracker
- Site visits are random and unannounced
- Interviews will be Conducted and will be private & confidential
- Payroll records are subject to review
- All apprenticeship programs will need to be approved by Department of Labor prior to starting
- Contractors are responsible for sub-contractor payroll
- Late payrolls delay contractor payments from SAWS

Contract Requirements

- Insurance requirements are found in Section 5.7 of the GCs
 - Builder's Risk is replaced by Installation Floater coverage (see Supplemental Conditions)
 - Maintain insurance coverage during the construction of this Project
- Compliant prior to executing the contract
- Will ask for insurance prior to Board award to expedite execution of the contract
 - Any deficiencies must be corrected prior to Board award

Contract Solicitations Website – Recent Changes

- To locate the Contract Solicitations website choose Resources

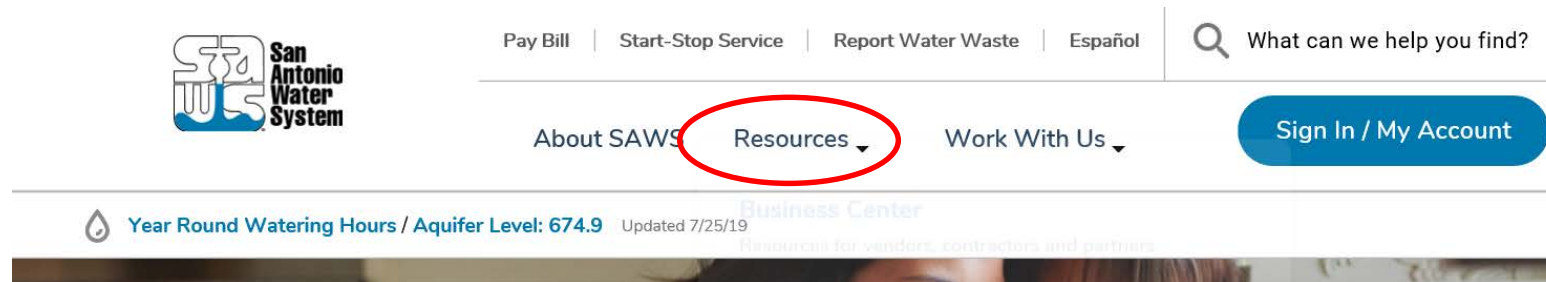

- At the drop down menu choose Contract Solicitations.

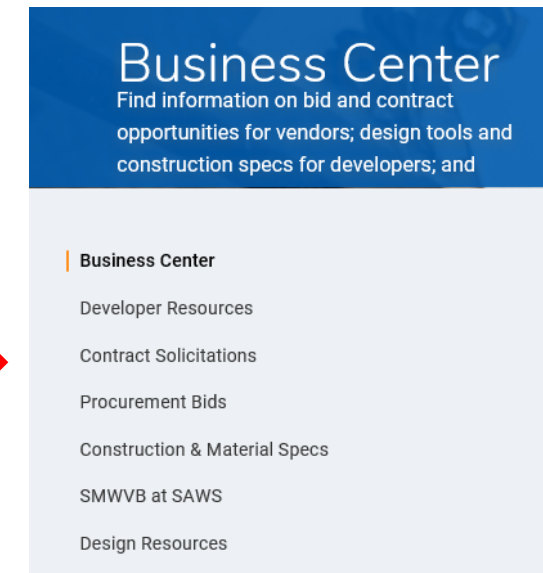

Contract Solicitations Website – Recent Changes

- Choose the specific project
- The following buttons are now located under the advertisement:
 - Notify Me
 - Plan Holder's List
 - Downloads
 - Plans
 - Specs
 - Addendums
 - Geotechnical Report



The screenshot displays a project advertisement for a "Non-Mandatory Pre-Bid Meeting" on August 6, 2019, at 10:00 AM. The location is the San Antonio Water System Customer Service Building. Below the advertisement, there are three main sections: "Notify Me" with a "Subscribe" button, "Plan Holders List" with a "View List" button, and a "Downloads" section. The "Downloads" section lists two PDF documents: "Specifications" and "Plans", both dated July 31, 2019, with a note that users must be logged in to access them. A red arrow from the text on the left points to the "Downloads" section in the screenshot.

Non-Mandatory Pre-Bid Meeting
10:00 AM, Tuesday Aug. 6, 2019
San Antonio Water System Customer Service Building, 2800 U.S. Hwy 281 N, San Antonio, Texas 78212; Conference Room CR-C145

Notify Me
Receive updates sent straight to your inbox.
[Subscribe](#)

Plan Holders List
View plan holders list.
[View List](#)

Downloads

Specifications
Jul. 31, 2019
Note: You must be logged in to access this document.

Plans
Jul. 31, 2019
Note: You must be logged in to access this document.

Vendor Registration & Notification (VRN)

- Please register through SAWS Vendor Registration Program on the SAWS website at www.saws.org to ensure access to the latest information.
- To receive updates on specific projects, registered vendors must 'Subscribe' to the project by selecting the project, and clicking 'Subscribe' under the Notify Me box.

https://apps.saws.org/Business_Center/Contractsol/



Notify Me

Receive updates sent straight to your inbox.



Subscribe

Key Reminders

- All questions should be sent in writing to the corresponding Contract Administrator by email or fax.
- Please identify the project by its associated solicitation number.
- Contractors should not contact the SAWWS project engineer, the consultants for this project, or any other SAWWS staff up until Board award.
- Late bids will not be accepted, and will be returned unopened.
- If mailing bids, ensure that sufficient time is allowed for the package to reach SAWWS.
- If bids will be delivered in person to SAWWS, Respondents should allow sufficient travel time, as well as time to check in at the guard station.

Contact Information

<u>Contact Name</u>	<u>Title</u>	<u>Telephone Number</u>	<u>Email address</u>
Fred Flores	Contract Administrator	210-233-3341	Fred.Flores@saws.org
Marisol V. Robles	SMWVB Program Manager	210-233-3420	Marisol.Robles@saws.org

Contract Background

- Sealed bids are requested by the San Antonio Water System for the construction of:
 - approximately 350 LF of 18” sanitary sewer main (Open Cut),
 - approximately 940 LF of 8” sanitary sewer main (Open Cut)
 - approximately 5340 LF of 8” sanitary sewer main (CIPP)
 - approximately 1200 LF of 10” sanitary sewer main (CIPP)
 - approximately 400 LF of 12” sanitary sewer main (CIPP)
 - approximately 600 LF of 24” sanitary sewer main (CIPP)and all associated work and appurtenances
- Project Fund will finance this expenditure included in the CY 2019
- Project is part of the Consent Decree
- Contractor is to become familiar with the plans, specifications, and project site.

Project Location Map

- Mossrock Dr.
- Dellwood Dr.
- Buckeye Ave.
- W. Kings Hwy
- Fredericksburg Rd.
- Dewberry St.
- Bandera Rd.
- Rivas St.
- I-35 Frontage Rd
- Dorie St.
- Niemeyers St.
- S. Olive St.
- E. Drexel Ave.
- Adele St.
- Berkshire Ave.
- Highland Blvd.
- Commercial Ave.
- Division Ave.
- Peabody Ave.
- S.W. Military Dr.

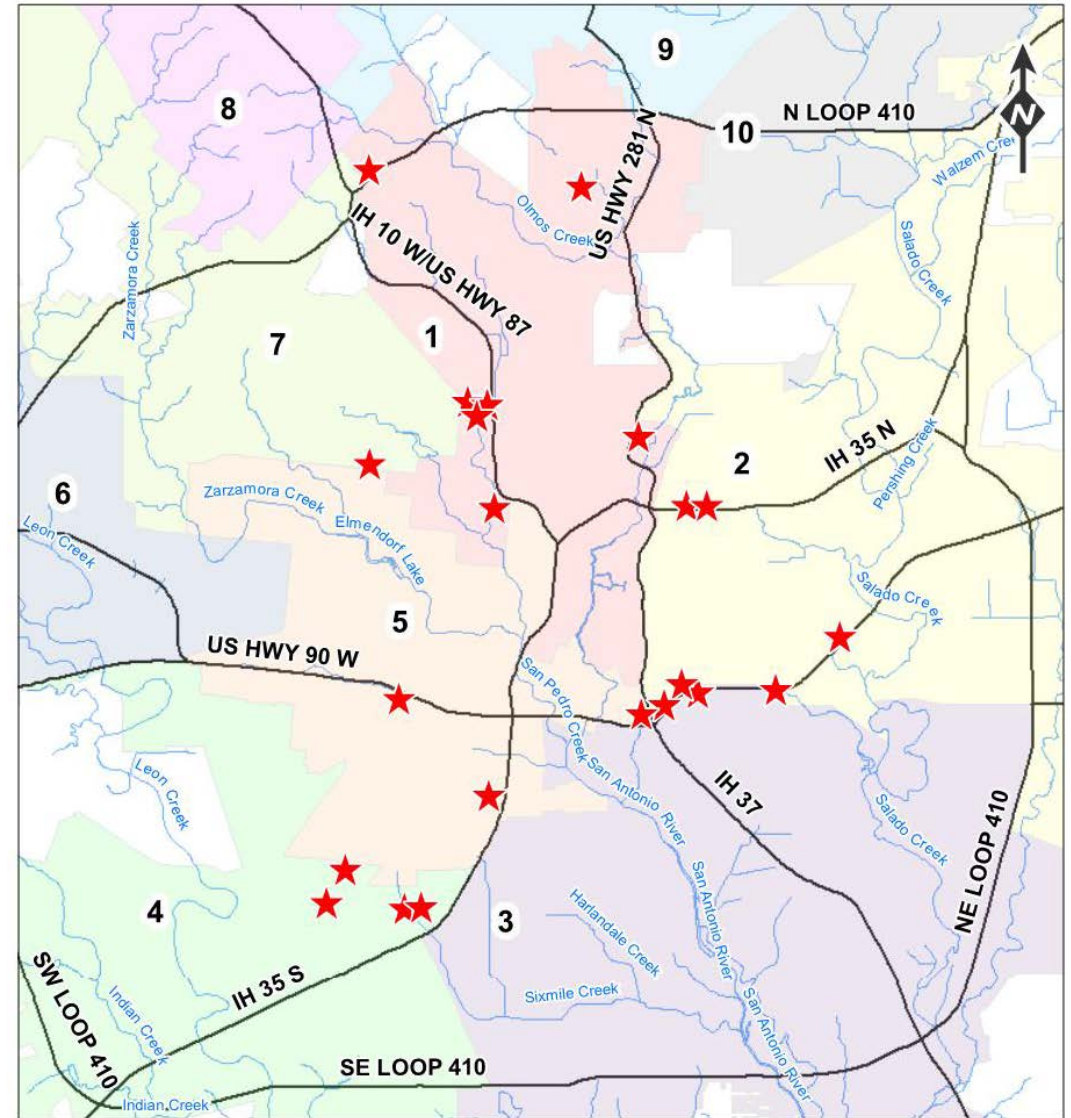

Contract Background

Special Conditions

- Contractor to submit a completion report when the project is complete
 - Pre and post MPEG-I video and video logs
 - Any tests and/or submittals specified in the Contract Documents
- Payment
 - The unit price cost for items shall include all the necessary incidental work as subsidiary to the item unless otherwise specifically called out in the plans or approved by SAWS

Contract Requirements

Supplemental Conditions

- Worksite
 - No excavation work of any kind may begin until authorized by SAWS
 - Preliminary work such as televising, utility investigation/potholing, setup and testing of bypass pumping may not begin until approval in writing by SAWS
- Consent Decree Notice Provisions
 - Retention of documents
 - Notification of events that may cause delay
 - Liability for stipulated penalties

Contract Requirements

Supplemental Conditions

- Contractor shall perform the Work with its own organization on at least 40% of the total original contract price.
- Liquidated damages will be assessed as follows for final completion extending beyond contract time of all Project Phases:

Liquidated Damages Charges		
Category	Duration (days)	Charge (\$) per day
Tier 1	1-7	\$460.00
Tier 2	8-14	\$540.00
Tier 3	15-21	\$600.00
Tier 4	22-28	\$640.00
Tier 5	29-35	\$670.00
Tier 6	36-42	\$690.00

- Any days tallied after 42 days will be assessed as a Tier 6 rate.

Contract Requirements

Special Provisions to Technical Specifications

- Sodding and seeding in COSA and TxDOT ROW are incidental to project (not a separate line item)
- Traffic control and bypass pumping are intended to be lump sums per each individual project site, not for the whole project
- Pump and haul bypass operations must be properly disposed of in a SAWWS wastewater receiving facility per Special Provision to Spec 864-SI
- Contractor shall obtain SWPPP from an engineer licensed in TX
- Pre and post-CCTV are done at each site, and paid under the line item “Sewer Main Television Inspection”

Contract Requirements

Special Provisions to Technical Specifications

- Hot water cured CIPP only – no steam or UV cured
- CIPP percentage of ovality is required to be 10%
- Verify point repair locations via pre-CCTV and confirm with SAWS Inspector prior to excavation
- In general, provide pre and post-CCTV data on USB-type drives, not CD's or VHS
- Remote cutting allowable on all laterals where feasible (Spec 1109)

Contract Requirements

Special Provisions to Technical Specifications

- Measurement and payment is modified for the following specifications (please verify you are bidding correctly):
 - 550 Trench Safety Protection
 - 855 Manhole Reconstruction
 - 910 Manhole Rehabilitation
 - 1103 Point Repairs
 - 1109 Lateral Reconnections
- In general, just double-check measurement and payment modifications in the special provisions

Project Requirements

Permits and Other

- City of San Antonio ROW permit
- Floodplain Permits for Sites 2, 9, and 12 (to be obtained by SAWWS)
- TxDOT ROW Permits for 7 Sites (to be obtained by SAWWS)
 - A minimum of 45 days of advanced notice is required to be provided to SAWWS when work is to commence on a project location which requires a TxDOT permit.
- Traffic control and pavement restoration plans are included in the plan drawing
 - Contractor responsible for traffic control plans for COSA segments unless included in plans.

Project Requirements

Permits and Other Continued

- City arborist pre-construction inspection
- Coordination with schools required for Project Locations 2, 11, & 18
- Rights of Entry
 - Contractor to obtain from SAWS prior to beginning work at those sites

Project Details

Project Milestones

Estimated work times in terms of weeks, and project site priorities related to permitting requirements, complexity, or interaction with other SAWWS projects

- Up to two (2) sites can be under construction concurrently
- Project Sites 9a and 9c are in the vicinity of the Martinez Creek Interceptor project; these need to be completed in the first 90 days of contract time to get ahead of the abandonment of the planned bypass MH
- All sites in TxDOT ROW to be done in first six months, to avoid re-permitting

Project Details

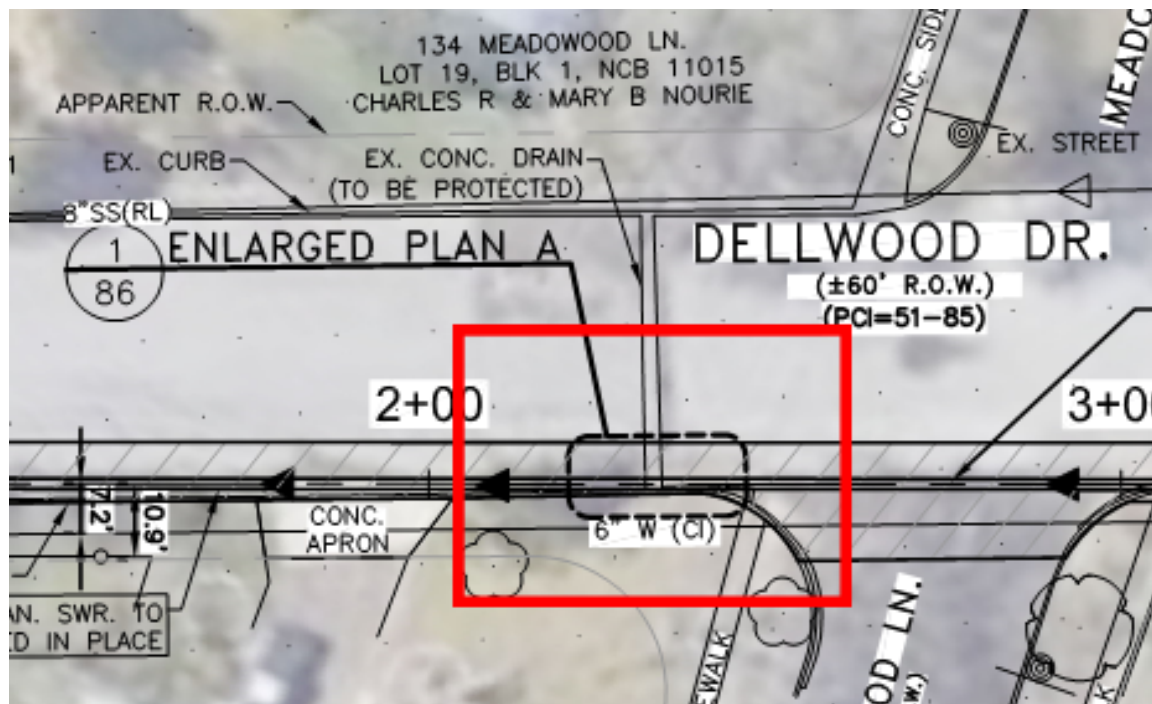

SITE 2

- Be careful with the storm drain! See details on Sheet 86 for recommended crossing replacement. Contractor will ensure stability and protection of existing storm drain.
- Two crepe myrtles exist near pipeline alignment – protect these trees!

Project Details



SITE 2

- Be careful with the storm drain! See details on Sheet 86 for recommended crossing replacement. Contractor will ensure stability and protection of existing storm drain.
- Two crepe myrtles exist near pipeline alignment – protect these trees!

Project Details



SITE 7

1. Clean, point repair and CCTV 24" line
 2. CIPP 24" line
 3. Tie over services from 12"/15" line and abandon
- Will need thorough pre-con CCTV to verify all services and point repair locations
 - Narrow working corridor

Project Details



SITE 8

- Adding a new MH at the existing PI (Sta 11+53)
- Narrow working corridor w/ other utilities

Project Details

SITES 10 & 11

- Both in line along IH-35 Southbound ROW
- Within TxDOT; will require permit
- Bypass plan recommends utilization of Storm Sewer inlets to cross streets & limit closures (RECOMMENDATION ONLY; CONTRACTOR TO DETERMINE BEST BYPASS METHOD)

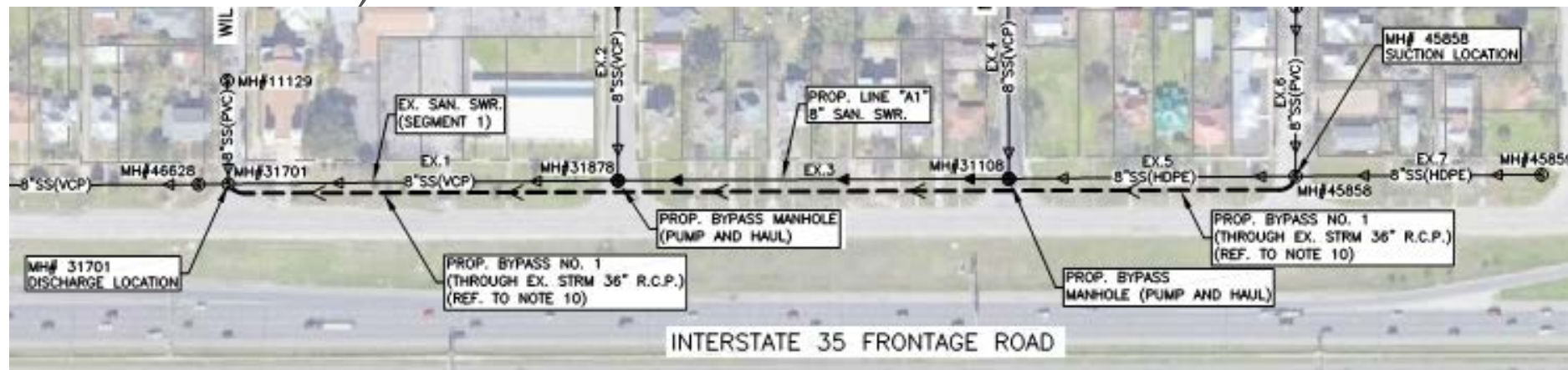

Project Details

SITES 15, 18 & 19

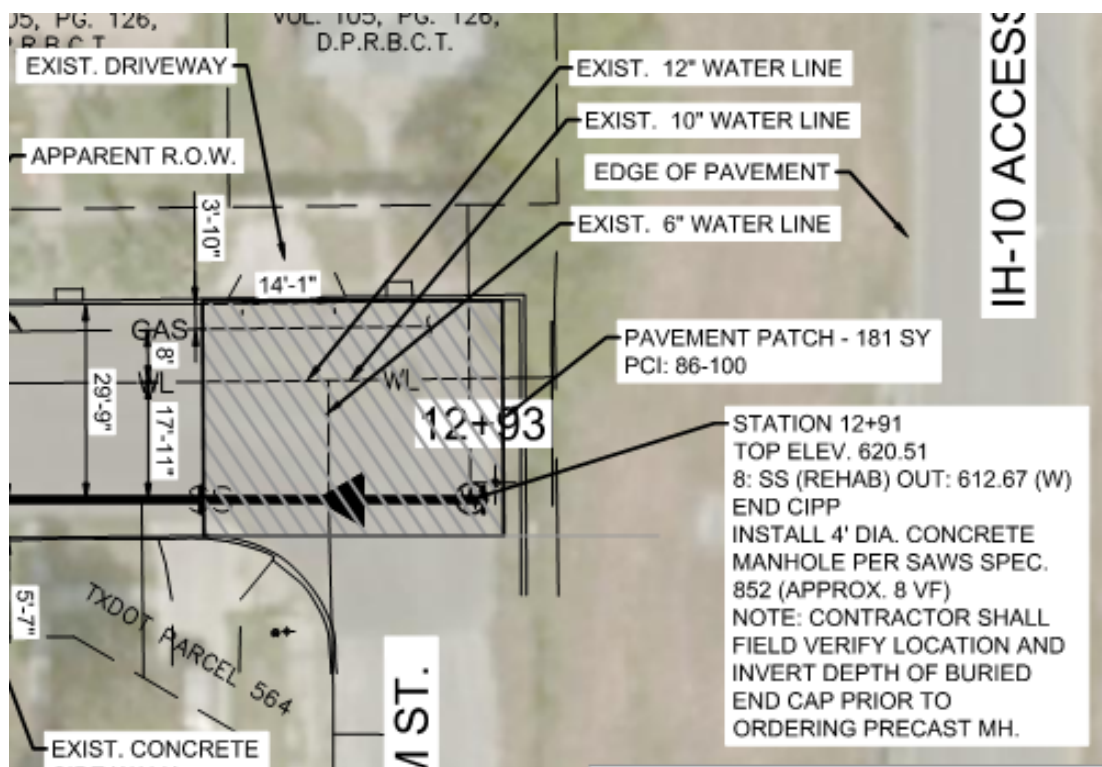

- Upstream ends of pipes are buried caps w/o MH's; pipes cut when Hwy corridor constructed in the 1960's/70's
- Intent is for contractor to install upstream MH within COSA ROW
- Site 19 is a high-PCI road; full reconstruction of intersection required

Project Details

SITE 20

- Complex bypass pumping required due to pipe gridding
- Project phased in attempt to facilitate bypass pumping during CIPP & MH rehab
- Segments in Division will require extensive traffic control (busy corridor)

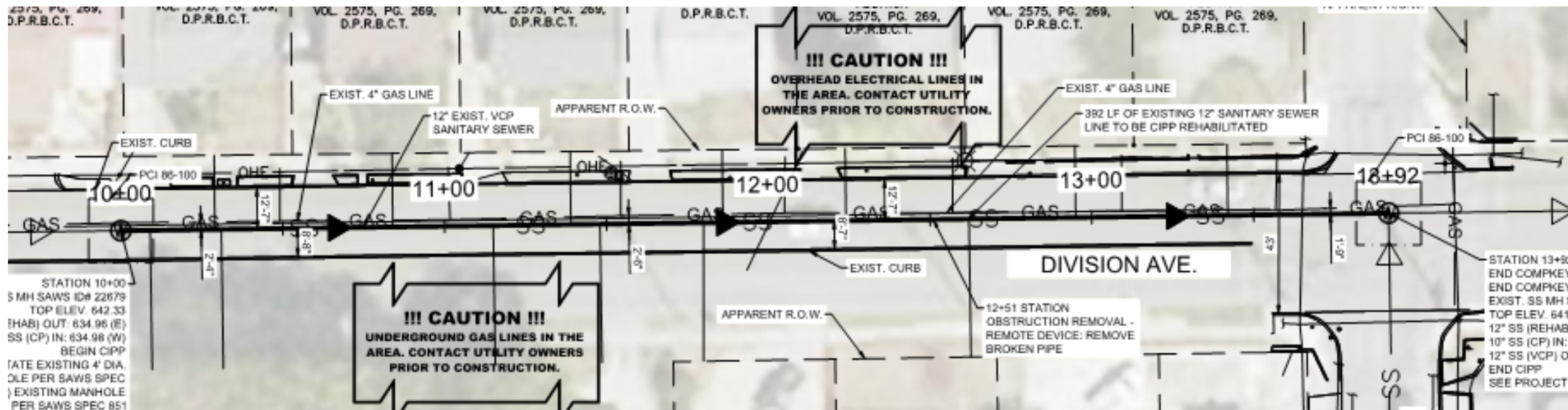

Project Details

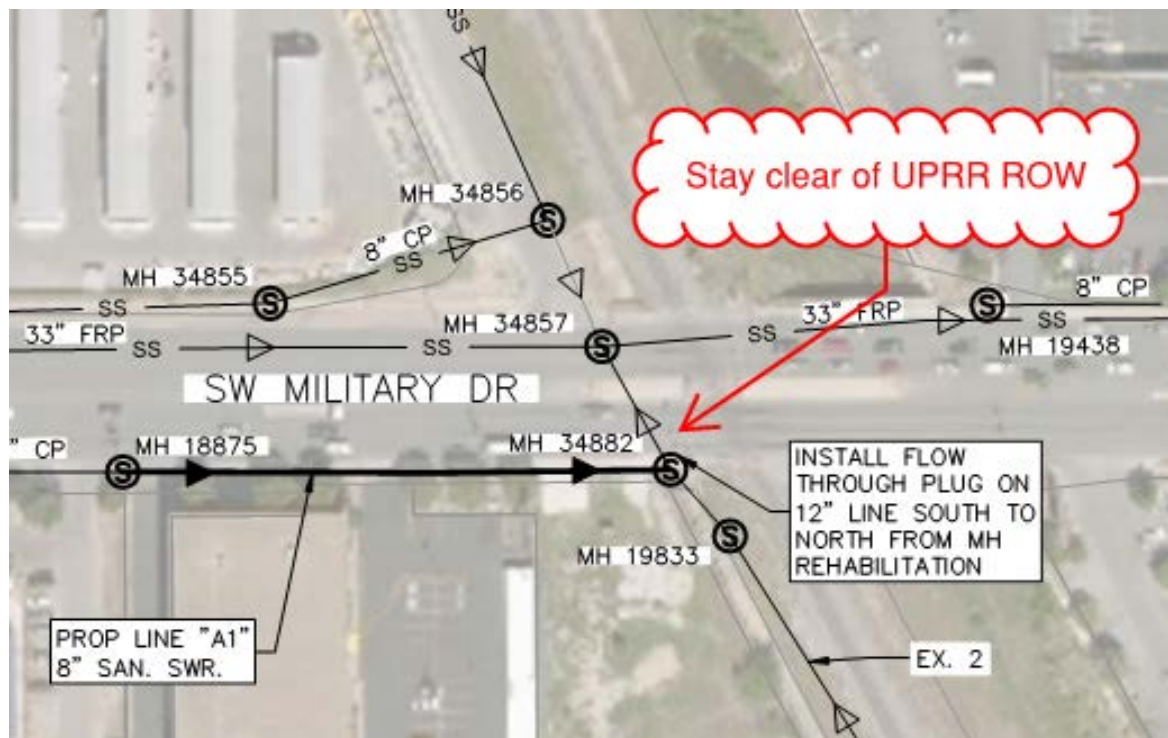

SITES 22, 23 & 24

- In TxDOT ROW
- Intent was to minimize bypass pumping footprint; several pump-and-hauls indicated in suggested bypass plan
- ROE and access will need to be carefully coordinated with property owners
- On Site 23, suggested bypass pumping plan is intended to keep clear of the UPRR ROW
- Work to be performed at night

QUESTIONS?

Reminder: Oral statements or discussion during the pre-bid meeting today will not be binding, nor will it change or affect the terms or conditions within the Plans and Specifications of this Project. Changes, if any, will be addressed in writing only via an Addendum.

BPC Central Small Diameter Package I

M. Antonio Leyva, P.E.

Manager – Engineering

Carmen C. Groth, P.E.

Project Engineer

Marisol V. Robles

SMWVB Program Manager

Fred Flores

Contract Administrator

Ian Patrick Toohey, P.E.

Project Engineer of Record

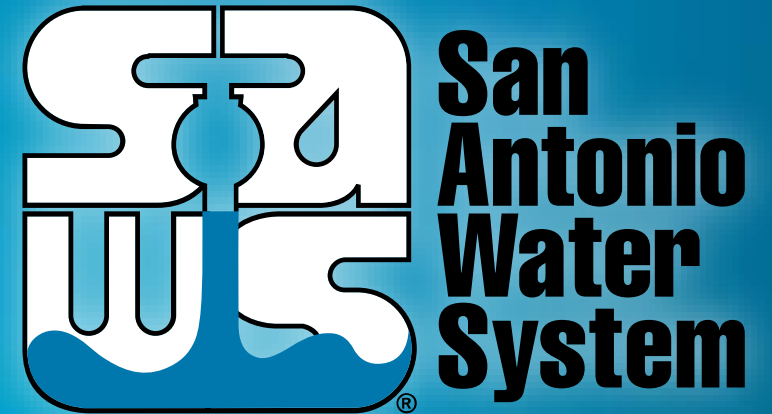

Non-mandatory Pre-Bid Meeting

August 15, 2019

MAKING SAN ANTONIO
WATERFUL 